

**Background** This document will show you how to connect to the TAFENSW wireless network on an Android device.

Due to multiple varieties of the Android Operating System we are unable to provide complete connection instructions for each device. You will be required to find the closest related possibility to the options listed below.

1. Select "Settings"

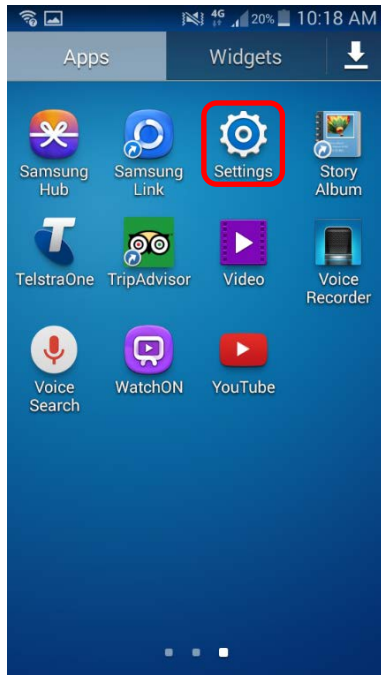

2. Select the "Wi-Fi" option

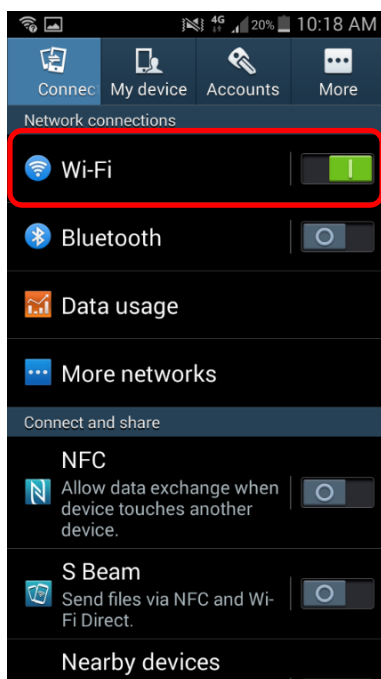

3. Select "TAFENSW" from list of available wireless networks

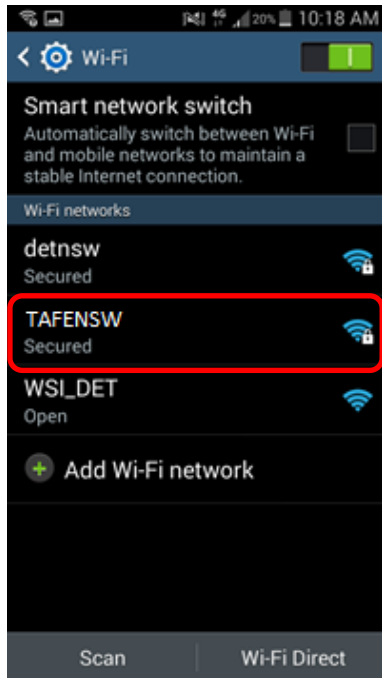

4. Scroll down to "Identity" and enter your TAFE Portal username (firstname.lastname1) and password

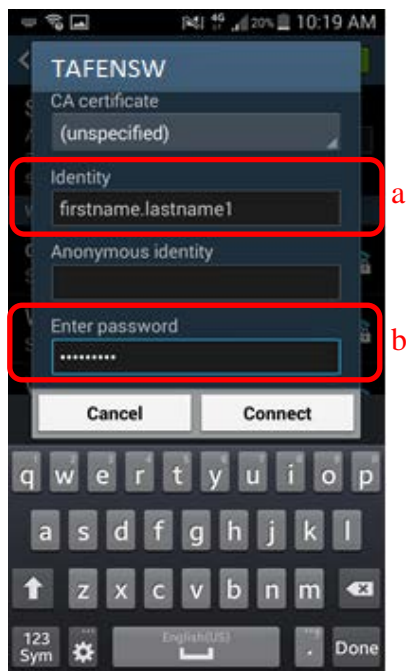

5. Scroll further and tick "Show advanced options" and in Proxy, select "Manual"

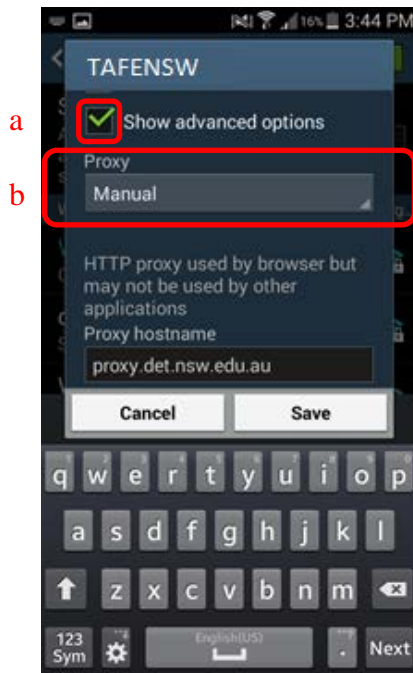

6. Enter in the Proxy Hostname as "proxy.tafensw.edu.au" and "8080" as the Proxy port and then click "Save"

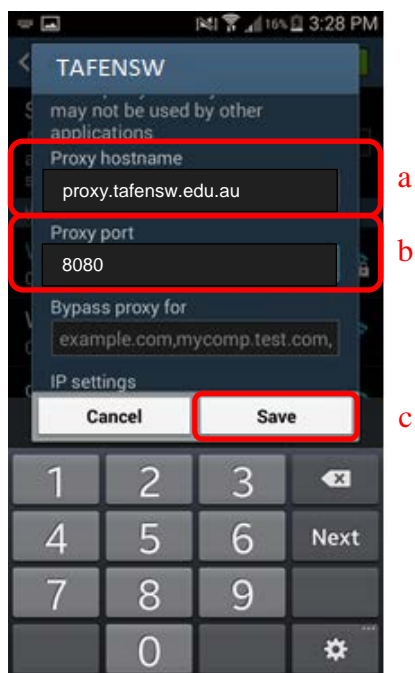

7. You are now connected to the "TAFENSW" wireless network